

Foundation plan

4WD dyno with mechanical axles connection

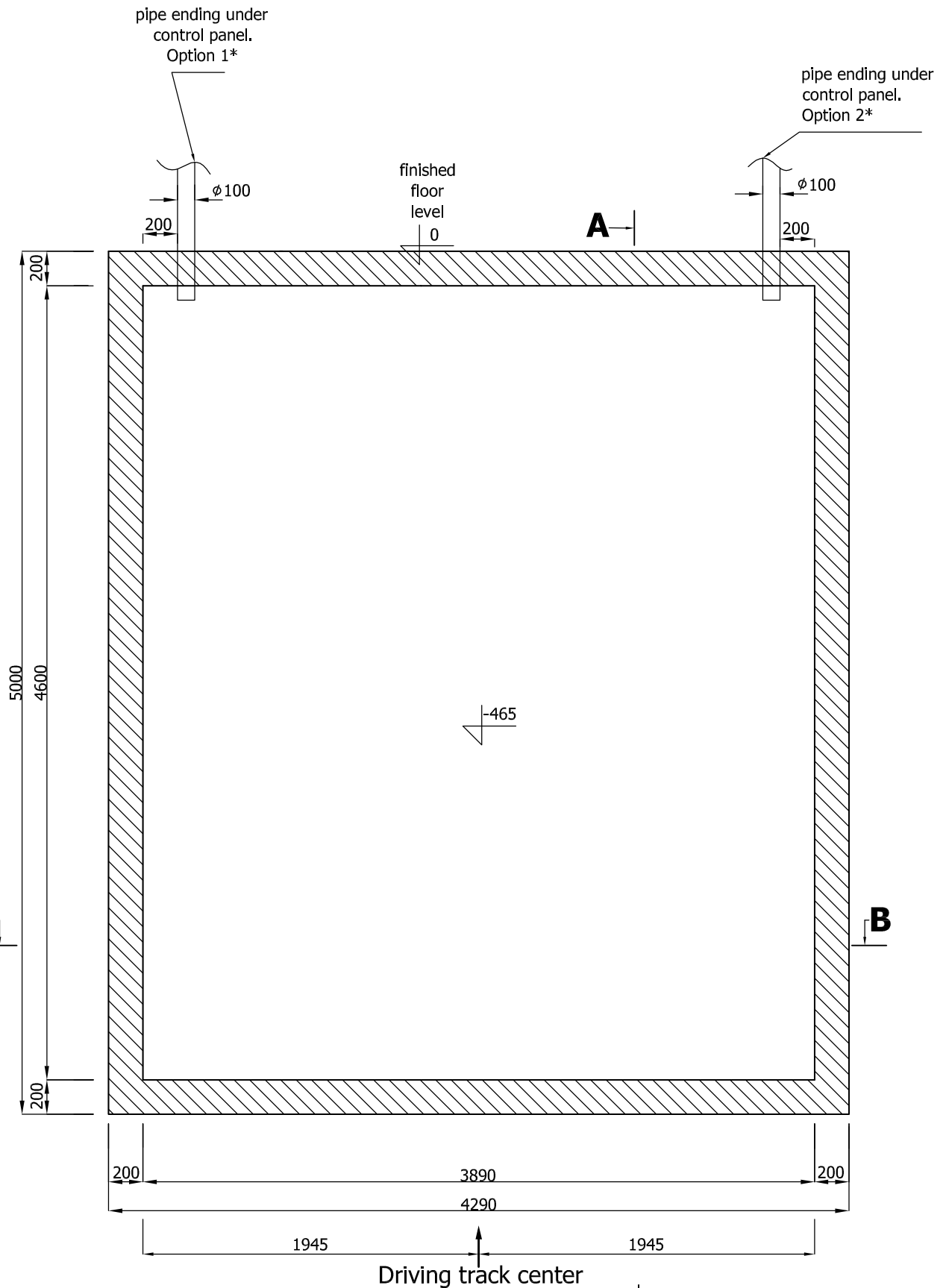

*) The customer inform in the order on which side a control panel will be installed. A cable conduit should be executed according to Option 1 or Option 2. Pipe end under control panel. Maximum lenght - 3m. Please don't use pipe elbows over 45°.

A-A

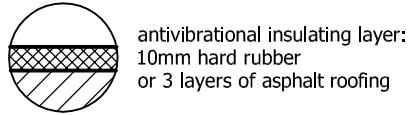
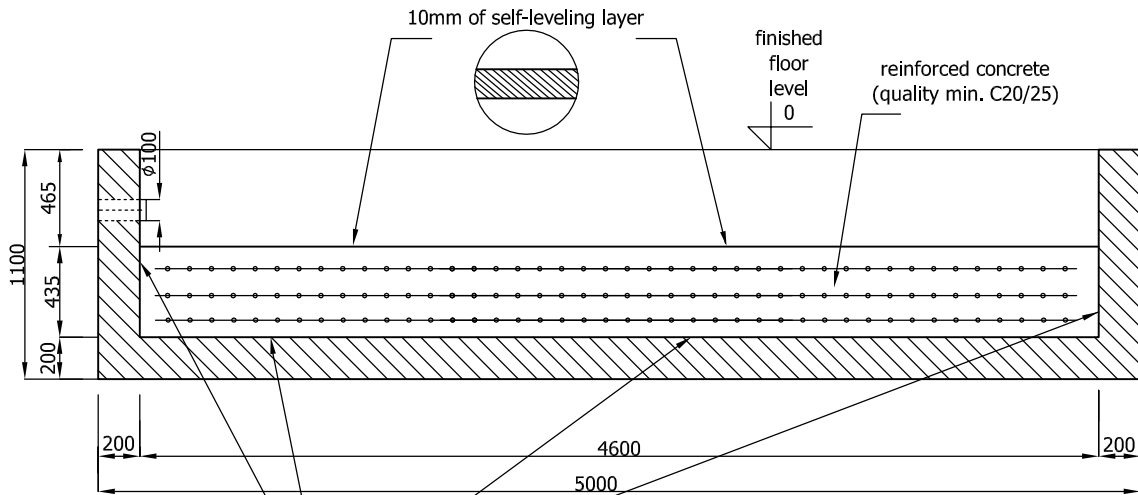

B-B

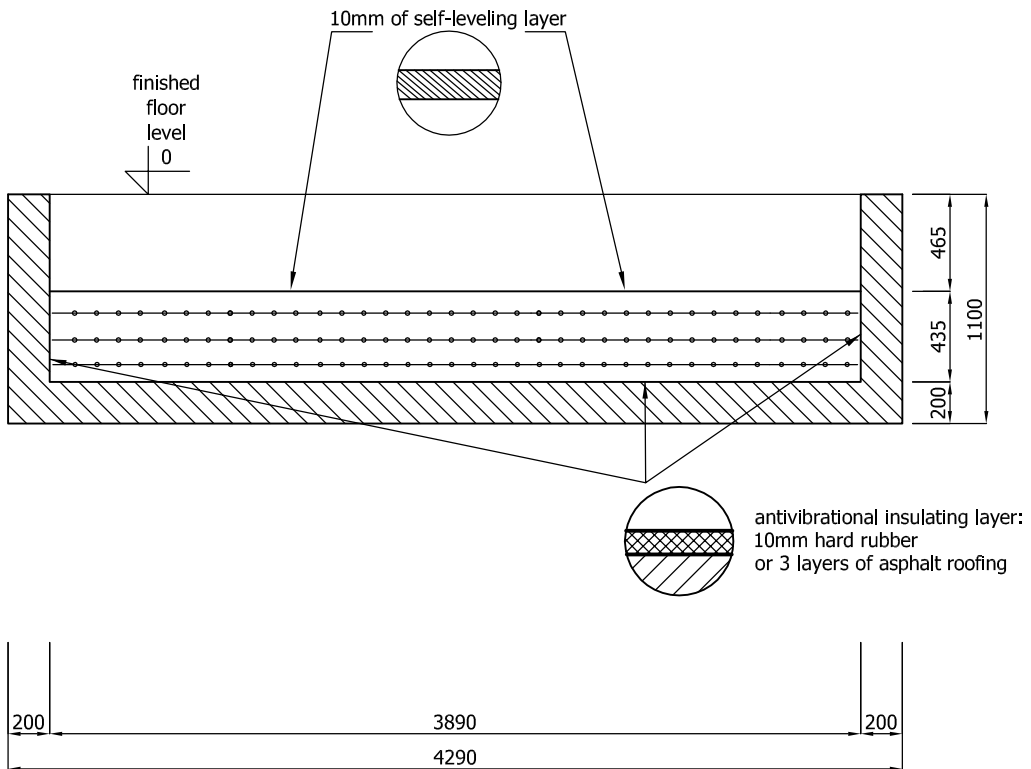

1. All dimensions in mm
2. The level tolerance is max. 2mm – we advise to use self-leveling layer
3. The tolerance of the other dimensions is 5mm
4. Close to the control panel (max 3m) should be available power supply (380V 63A) and compressed air (7bar)
5. Between the door of garage and the pit at least 1300mm space is required for sliding rear covers
6. The buyer is responsible for checking all dimensions! Rectangularity of foundation must be absolutely maintained!
7. Supplier reserved the right to check the foundation 7-10 days before installation